

Appendix 1

NOTE: This drawing is subject to copyright, no portion is to be used without prior consent. This scheme is subject to Town Planning, Building Regulations and all other necessary consents. Dimensions, Areas and levels where given are subject to a site survey and are to be checked on site prior to construction.

This project falls under the Construction Design and Management Regulations 2015 whether domestic or commercial. As the client you have specific duties under these regulations. These duties are a legal requirement. For information on your responsibilities please go to www.HSE.gov.uk then CDM Regulations 2015.

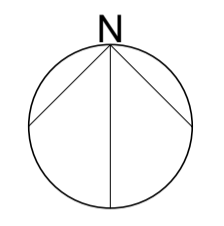
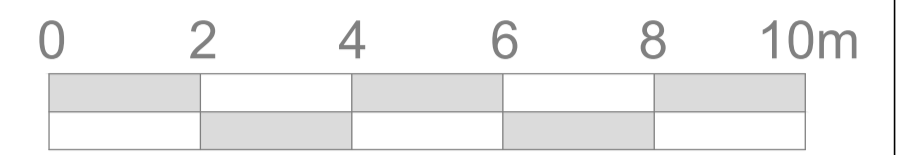

Application Area



Rev	Date	Amendments
P L A N N I N G		

Client:
**Mansbridge And Murray
 Developments Limited**



39 Hartington Place, Letchworth Garden City, Hertfordshire, SG6 1FA
 E: Luke.Kenton@kw-architectural.co.uk - M: 07812 98924

Project:
**Dropped Kerb Application,
 39 Wootton Village,
 Boars Hill, Oxon, OX1 5HP**

Drawing Title:
Existing Site Plan

Drawn By: **LKW** Date: **April 2023**

Scale: **1:100** Size: **A1**

Job / Drawing Number: **544-PL02** Revision: **-**

NOTE : This drawing is subject to copyright, no portion is to be used without prior consent. This scheme is subject to Town Planning, Building Regulations and all other necessary consents. Dimensions, Areas and levels where given are subject to a site survey and are to be checked on site prior to construction.

This project falls under the Construction Design and Management Regulations 2015 whether domestic or commercial. As the client you have specific duties under these regulations. These duties are a legal requirement. For information on your responsibilities please go to www.HSE.gov.uk then CDM Regulations 2015.

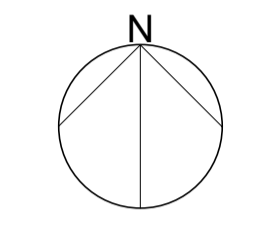
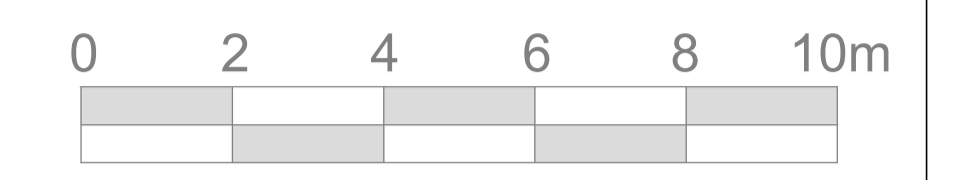

Application Area

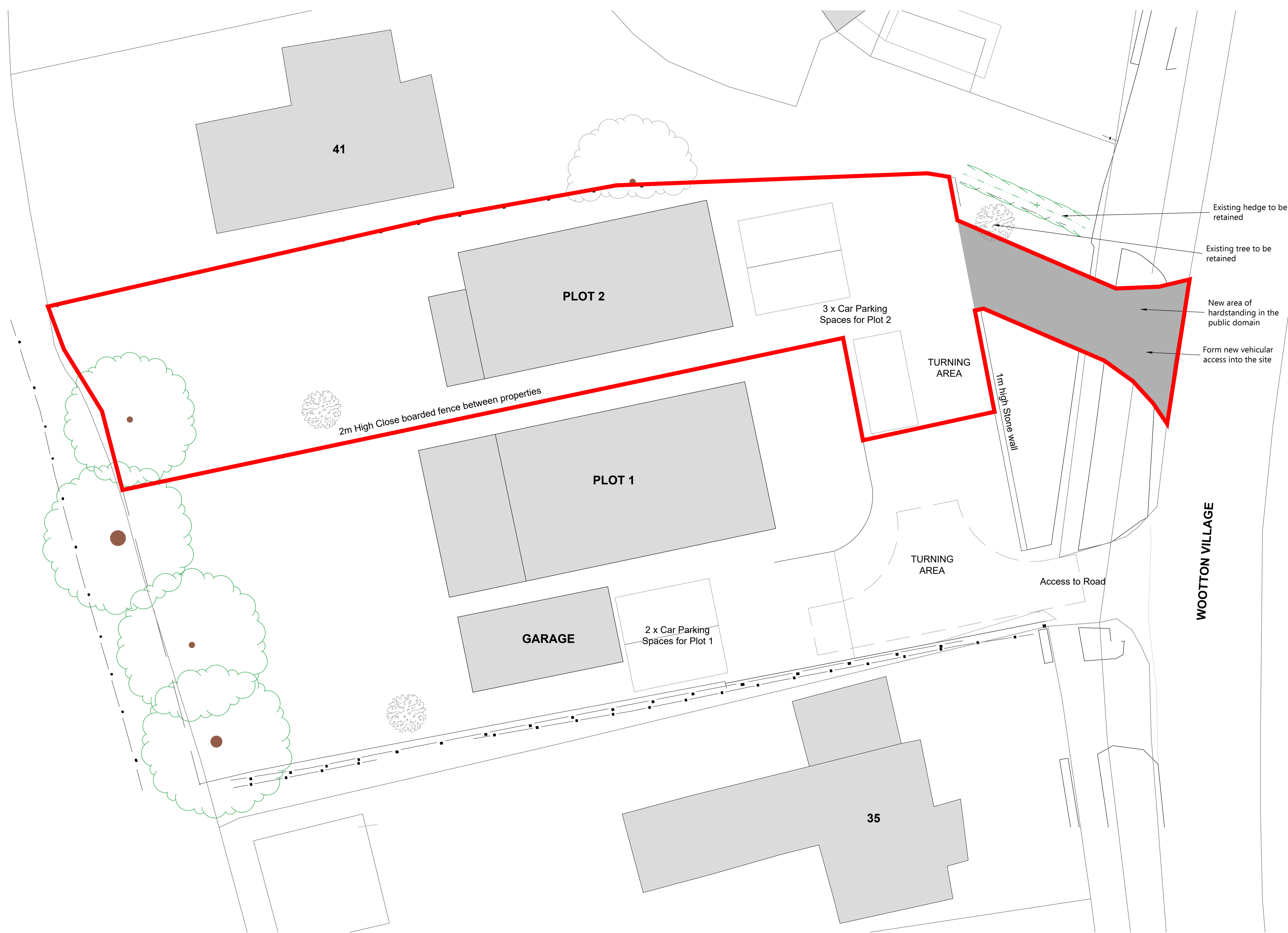

Rev	Date	Amendments
P L A N N I N G		

Client:
**Mansbridge And Murray
 Developments Limited**



39 Hartington Place, Letchworth Garden City, Hertfordshire, SG6 1FA
 E: Luke.Kenton@kw-architectural.co.uk - M: 07812 98924

Project:
**Dropped Kerb Application,
 39 Wootton Village,
 Boars Hill, Oxon, OX1 5HP**

Drawing Title:
Proposed Site Plan

Drawn By: **LKW** Date: **November 2022**

Scale: **1:100** Size: **A1**

Job / Drawing Number: **544-PL03** Revision: **-**

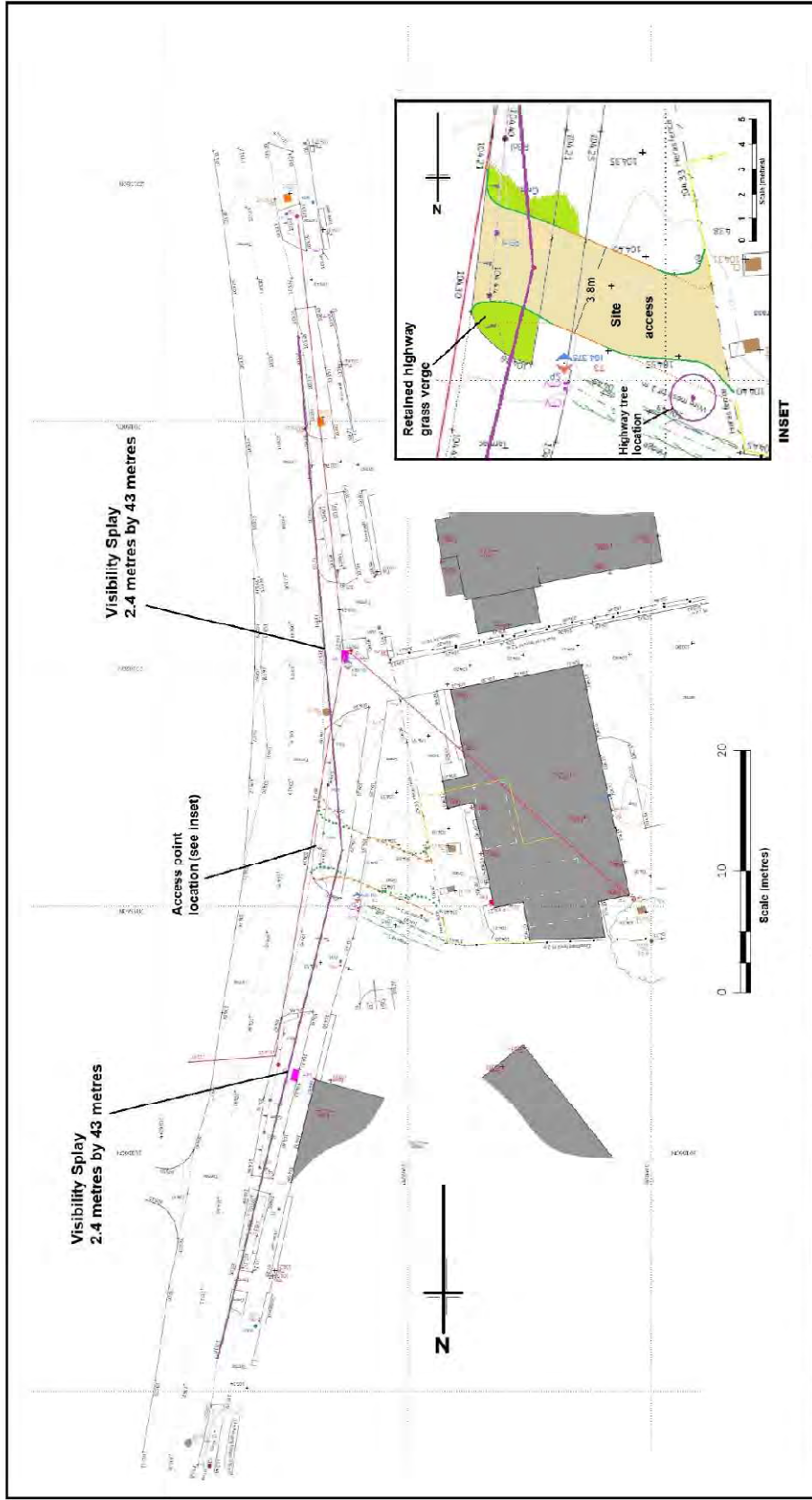

PROPOSED DRIVEWAY / DROPPED KERB Ref: Planning Application P23/V1093/HH	39 Wootton Village, Boars Hill, Oxon OX1 5HP	Drawing No 23061/101	Date June 2023
		Scale As shown	Scale As shown