

Appendix One

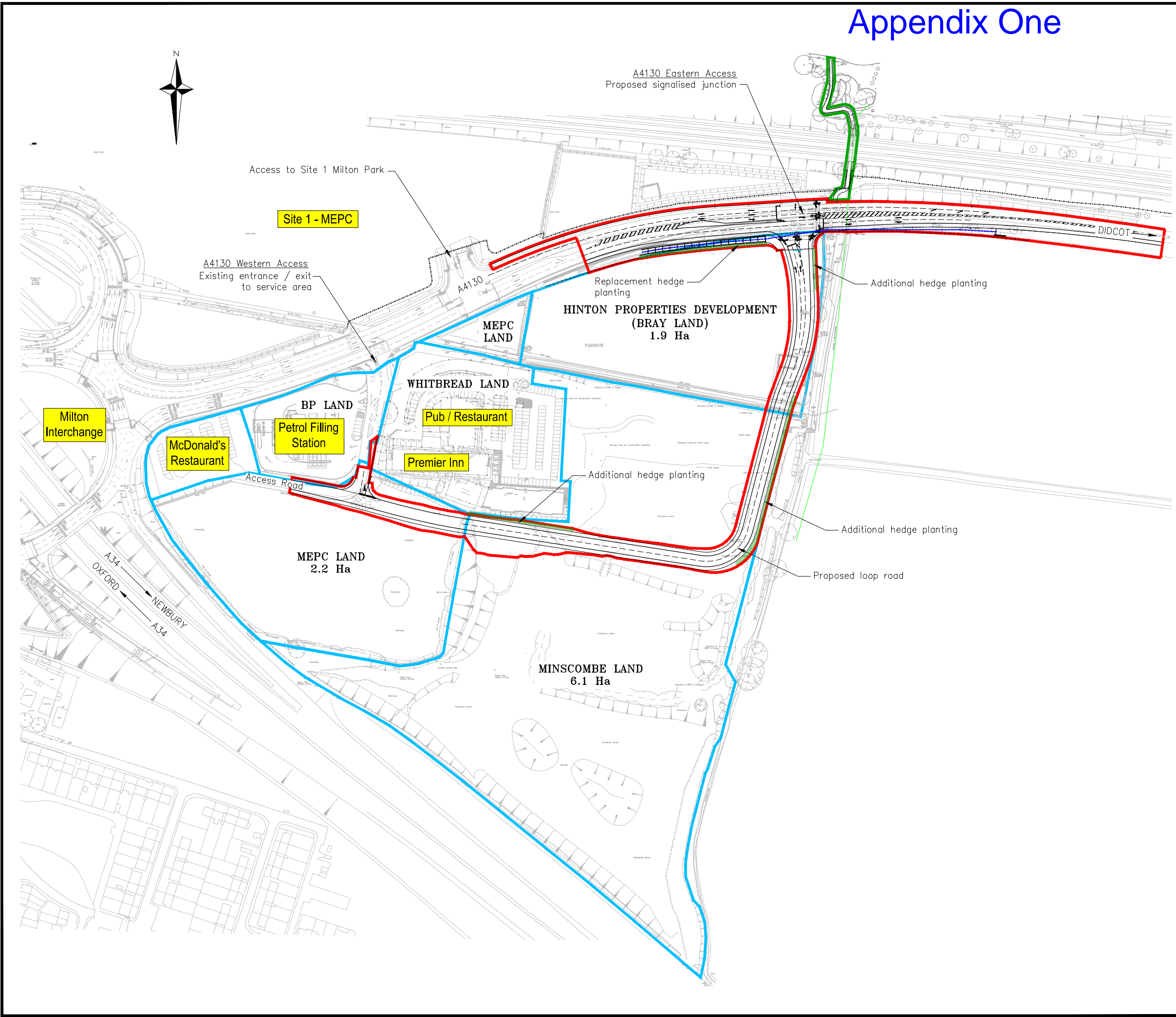

NOTES

1. This drawing to be read in conjunction with all relevant documents and specifications.
2. Dimensions not to be scaled.

KEY

- Application boundary (1.9 Ha)
- Land ownership boundaries
- Footpath link to be delivered by MEPC

	Length
Approximate extent of existing hedge to be removed	191m
Proposed hedge planting	304m

Rev.	Description	Date	Chkd
G	Base survey updated.	13/12/13 D.Strange	TF
F	Additional replacement hedge added.	04/11/13 J.Blenkinsop	TF
E	Replacement hedge added.	30/10/13 J.Blenkinsop	TF
D	Footway added to the northern side of the A4130, application boundaries amended to suit.	10/10/13 J.Blenkinsop	TF
C	Amendments to application boundary.	02/10/13 J.Blenkinsop	TF
B	Amendments in response to Road Safety Audit.	11/03/13 J.Blenkinsop	TF
A	Amendments to land ownership boundaries.	26/02/13 J.Blenkinsop	TF



Glanville
 Cornerstone House
 62 Foxhall Road, Didcot
 Oxon, OX11 7AD
 Tel: (01235) 515550 Fax: (01235) 817799
 postbox@glanvillegroup.com www.glanvillegroup.com

Client : Minscombe Properties Limited,
 Hinton Properties, Mr Bray and mepc Milton Park

Project : Land South of A4130

Title : Development Proposals

Project Engineer : T. Foxall Scale : 1:2500 @ A3
 Project Director : J. Birch Date : February 2013

Status :

Drawing No. 280799/SK09 Rev G

Appendix Two

Do not scale from this drawing. Refer to figured dimensions only. Thinking Buildings Limited registered in England and Wales No. 7636362. This drawing is copyright of Thinking Buildings Ltd.

N

Drawing Scale Bar			
Drawing scale	Line length	Drawing scale	Line length
1:5	= 0.25 metres	1:200	= 10.0 metres
1:10	= 0.5 metres	1:250	= 12.5 metres
1:20	= 1.0 metres	1:500	= 25.0 metres
1:25	= 1.25 metres	1:1000	= 50.0 metres
1:50	= 2.5 metres	1:1250	= 62.5 metres
1:100	= 5.0 metres	1:2500	= 125 metres

← Measure length of line above for checking of scale →

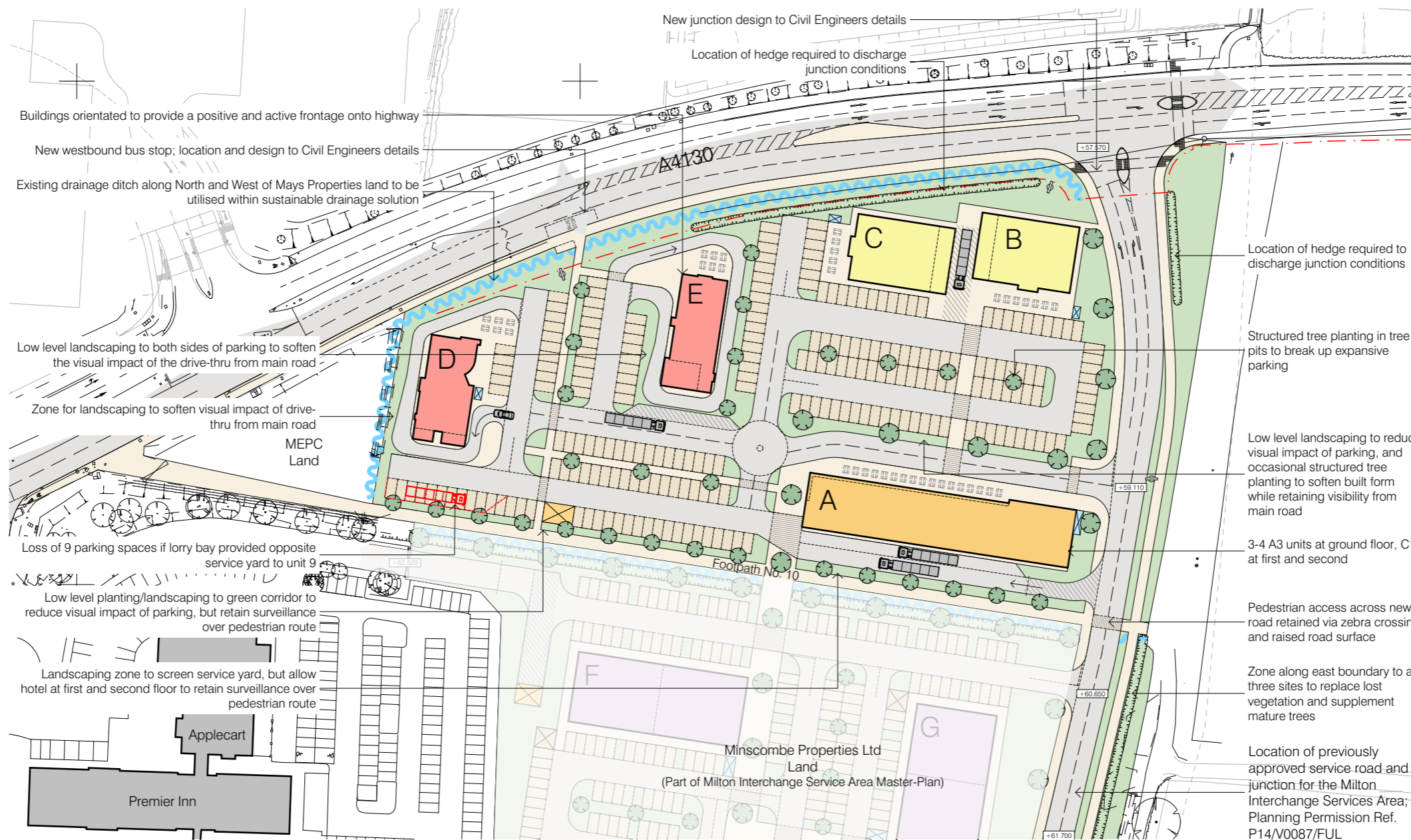

N

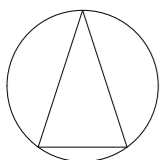

PARKING:
Mays Land
Parking: 229 Spaces
(OCC Parking Max: 243 Spaces)

KEY:
Block A - Class A1/A3/C1
Area: 2,587m²
Ground Floor (Class A1 Non-Food): 120m²
Ground Floor (Class A1 Food): 361m²
Ground Floor (Class A3): 224m²
Ground Floor (Class C1): 126m² (inc bins)
First/Second Floor (Class C1): 878m² (each)

Block B - Class A3
Area: 408m² (inc. servicing encl.)
Block C - Class A3
Area: 408m² (inc. servicing encl.)
Block D - Class A5
Area: 320m² (inc. servicing encl.)
Block E - Class A5
Area: 332m² (inc. servicing encl.)

- Sustainable Urban Drainage Corridors
- Proposed Cycle Parking/Storage
- Proposed Refuse Store Locations
- Proposed Sub-Station Locations

01

Proposed Site Plan

1:1250

Rev	Date	By	Chd
A	11.12.2015	GW	DA
/	30.11.2015	GW	DA

Amended to SITE PLAN
First issue
Details

Client:
Minscombe Properties Ltd and
Mays Properties Ltd

Project:
Minscombe + Mays Commercial Site Development
Milton Interchange

Drawing:
Proposed Master-Plan (Mays)
Proposed Site Plan

Print Size: A3
Project No: 1433
Drawing No: 20
Revision: A

Drawing Status:
PLANNING

L:\BIM Files\1433_Minscombe May Masterplan\1433_Architect Master File_Master Plan_Planning02.pln



Oxfordshire: 01295 722830 • Derbyshire: 01332 416 405
e: email@thinking-buildings.co.uk
www.thinking-buildings.co.uk

Do not scale from this drawing. Refer to figured dimensions only. Thinking Buildings Limited is registered in England and Wales.

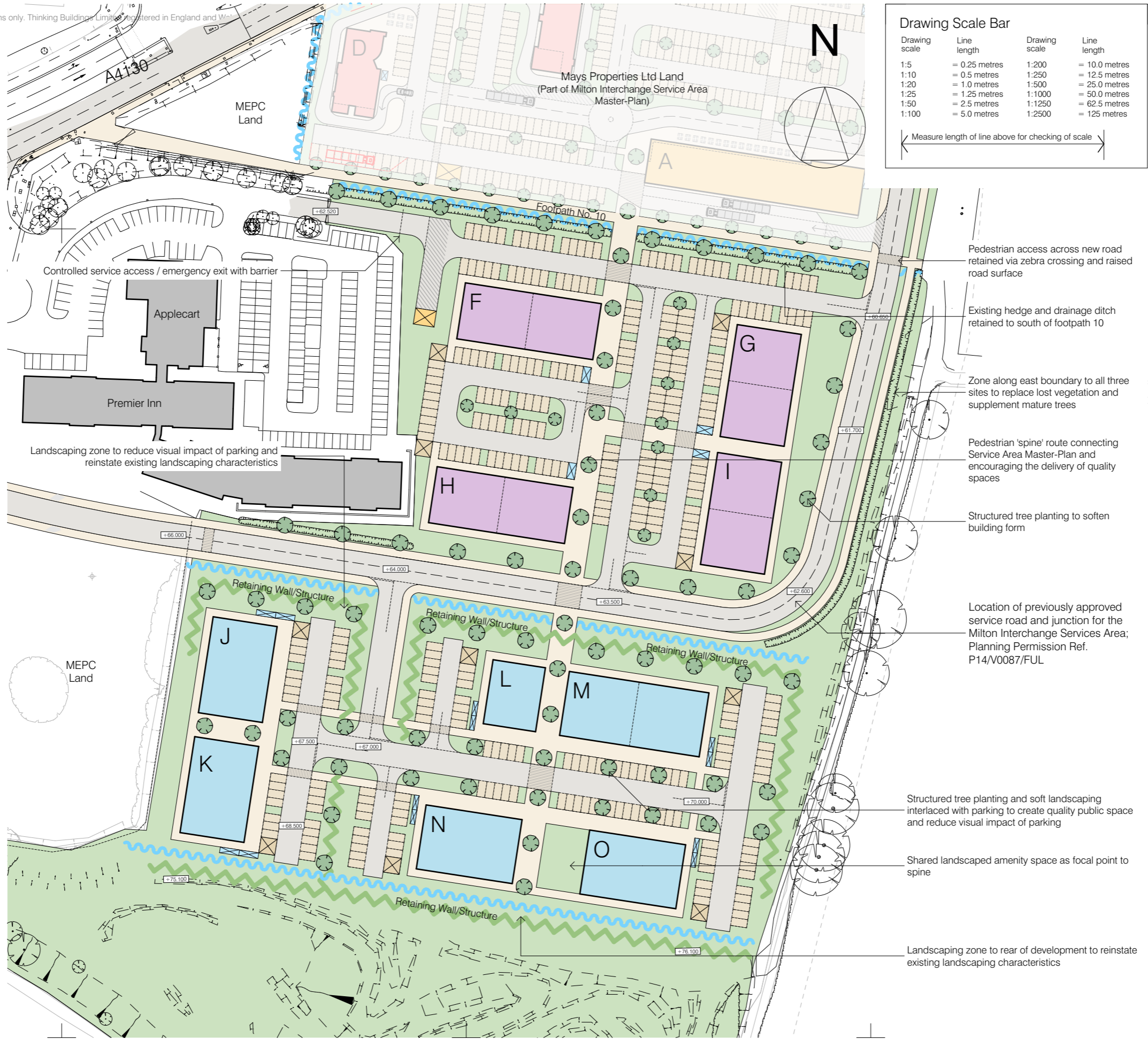

Drawing Scale Bar

Drawing scale	Line length	Drawing scale	Line length
1:5	= 0.25 metres	1:200	= 10.0 metres
1:10	= 0.5 metres	1:250	= 12.5 metres
1:20	= 1.0 metres	1:500	= 25.0 metres
1:25	= 1.25 metres	1:1000	= 50.0 metres
1:50	= 2.5 metres	1:1250	= 62.5 metres
1:100	= 5.0 metres	1:2500	= 125 metres

← Measure length of line above for checking of scale →

PARKING:

Minscombe Land - Lower Tier
 Parking: 192 Spaces
 (OCC Parking Max: 193 Spaces)

Minscombe Land - Middle Tier
 Parking: 134 Spaces
 (OCC Parking Max: 120 Spaces)

KEY:

Building Zone F
 Area: 1,488m² (two storey)

Building Zone G
 Area: 1,402m² (two storey)

Building Zone H
 Area: 1,488m² (two storey)

Building Zone I
 Area: 1,402m² (two storey)

Building Zones J
 Area: 600m² (one storey)

Building Zones K
 Area: 600m² (one storey)

Building Zone L
 Area: 327m² (one storey)

Building Zone M
 Area: 873m² (one storey)

Building Zone N
 Area: 600m² (one storey)

Building Zone O
 Area: 600m² (one storey)

Sustainable Urban Drainage Corridors

Gabion wall location to address level changes

Proposed Cycle Parking/Storage

Proposed Refuse Store Locations

Proposed Sub-Station Locations

Rev	Date	By	Chd
A	11.12.2015	GW	DA
/	30.11.2015	GW	DA

Amended to SITE PLAN
 First issue
 Details

PLANNING

Drawing Status: /

L:\BIM Files\1433_Minscombe May Masterplan\1433_Architect Master File_Master Plan_Planning02.pln

Client: Minscombe Properties Ltd and Mays Properties Ltd

Project: Minscombe + Mays Commercial Site Development Milton Interchange

Drawing: Proposed Master-Plan (Minscombe) Proposed Site Plan

Print Size: A3

Project No: 1433

Drawing No: 25

Revision: /



Oxfordshire: 01295 722830 • Derbyshire: 01332 416 405
 e: email@thinking-buildings.co.uk
 www.thinking-buildings.co.uk

01

Proposed Site Plan

1:1250

Drawing Scale Bar			
Drawing scale	Line length	Drawing scale	Line length
1:5	= 0.25 metres	1:200	= 10.0 metres
1:10	= 0.5 metres	1:250	= 12.5 metres
1:20	= 1.0 metres	1:500	= 25.0 metres
1:25	= 1.25 metres	1:1000	= 50.0 metres
1:50	= 2.5 metres	1:1250	= 62.5 metres
1:100	= 5.0 metres	1:2500	= 125 metres

← Measure length of line above for checking of scale →

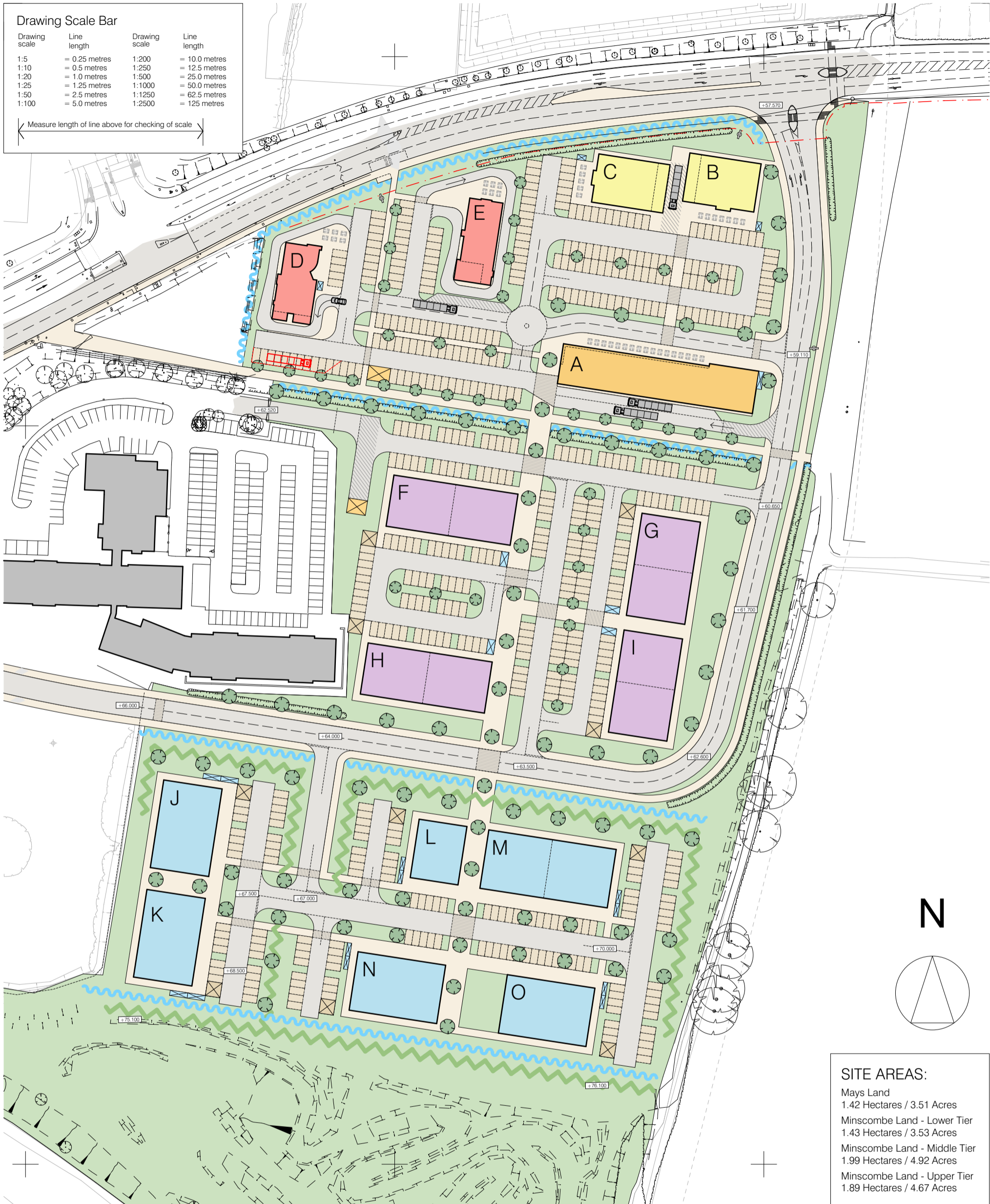

01

Indicative Milton Interchange Service Area Master-Plan

1:1250



Client:
Minscombe Properties Ltd and
Mays Properties Ltd

Project:
Minscombe + Mays Commercial Site Development
Milton Interchange

Drawing:
Service Areas Master-Plan
Indicative Milton Interchange Service Area Master-Plan, Context Plan

Rev	Details	Date	By	Ch'd
F	Amended to INDICATIVE Milton Interchange Service Area Master-Plan	11.12.2015	GW	DA
E	Master-plan updated to reflect SK18 and information stripped from drawing	30.11.2015	GW	DA

Oxfordshire, t: 01295 722830 • Derbyshire, t: 01332 416 405
e: email@thinking-buildings.co.uk
www.thinking-buildings.co.uk

Print Size: A3 Project No: 1433 Drawing No: 10 Revision: F

Drawing Status:
PLANNING

L:\BIM Files\1433_Minscombe May Masterplan\1433_Archicad Master File_Master Plan_Planning02.pln