

LAYOUT OF THE FAR FIELD TEST RANGE

DESCRIPTION

Locations	Locations				
	Easting	Northing	Latitude	Longitude	OS Grid
Rx Tower	447762	185677	51.567947	-1.3123003	SU 47762 85677
Rx Storage Cabin	447771	185699	51.568147	-1.3121621	SU 47771 85699
Rx Storage Cage	447771	185699	51.568147	-1.3121621	SU 47771 85699
20' ISO Container	447771	185699	51.568147	-1.3121621	SU 47771 85699
Car Park	447757	185710	51.568250	-1.3123653	SU 47757 85710
Tx Cabin	447409	185726	51.568418	-1.3173857	SU 47409 85726

Key

- Existing taxiway and hardstanding
- Boundaries
- Roads
- Trees
- Buildings
- Vehicle access
- Line of sight
- Palisade fencing

Revision	Revision date	Revision notes	15058.COM.A010
1	21/08/2015	Moved storage cabins; comments; Upper Farm trees	
2	25/08/2015	Title changed; houses added; scale; sheet size	
3	04/09/2015	Tower pos'ns; extra detail view A014; extended path for Tx	
4	07/09/2015	Line of sight; duct detail; annotations	

PROJECT NO: 15058
 CLIENT NAME: SAC
 DRAWING NO: Preliminary
 DATE DRAWN: 18/08/2015
 DRAWN BY: A. Aljo
 CHECKED BY:
 SCALE: 1:2000
 SHEET NO: A2
 PART NO: N/A
 MATERIAL: N/A
 TYPE: N/A
 REFER TO DRAWING: Refer to drawing
SITE ONE
 Unit 18 Nolley Farm, Chowney Road
 Long Preston, Aylesbury
 Buckinghamshire
 HP18 8ER
 United Kingdom
 T +44 (0) 1848 208 983
 E. info@siteone.co.uk

- COMMENTS**
- Do not scale this drawing.
 - All dimensions in mm unless otherwise stated.
 - All material to be grade S275J0 or S355J0 (or J2), in compliance with BS 10025.
 - All metalwork, including fasteners, to be hot-dip galvanized to BS EN 14146. All fasteners to be minimum grade 8.8, in compliance with BS 4190, and supplied with a square section spring washer and full nut. Minimum hole clearance for fasteners should be 1mm greater than the nominal fastener diameter.
 - No thermal cutting to be used in process. All parts to be laser-cut where possible, including bolt holes. Laser-cutting is not a thermal-cutting process.

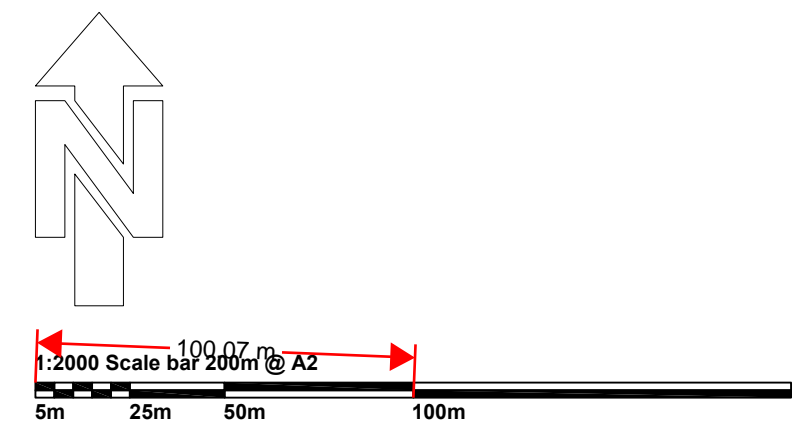
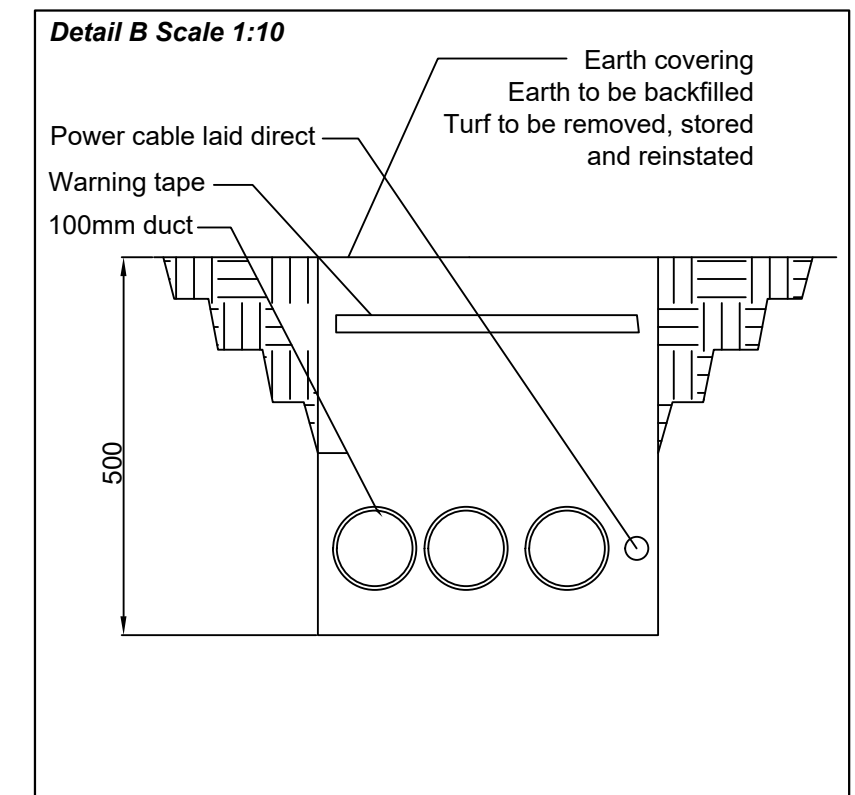
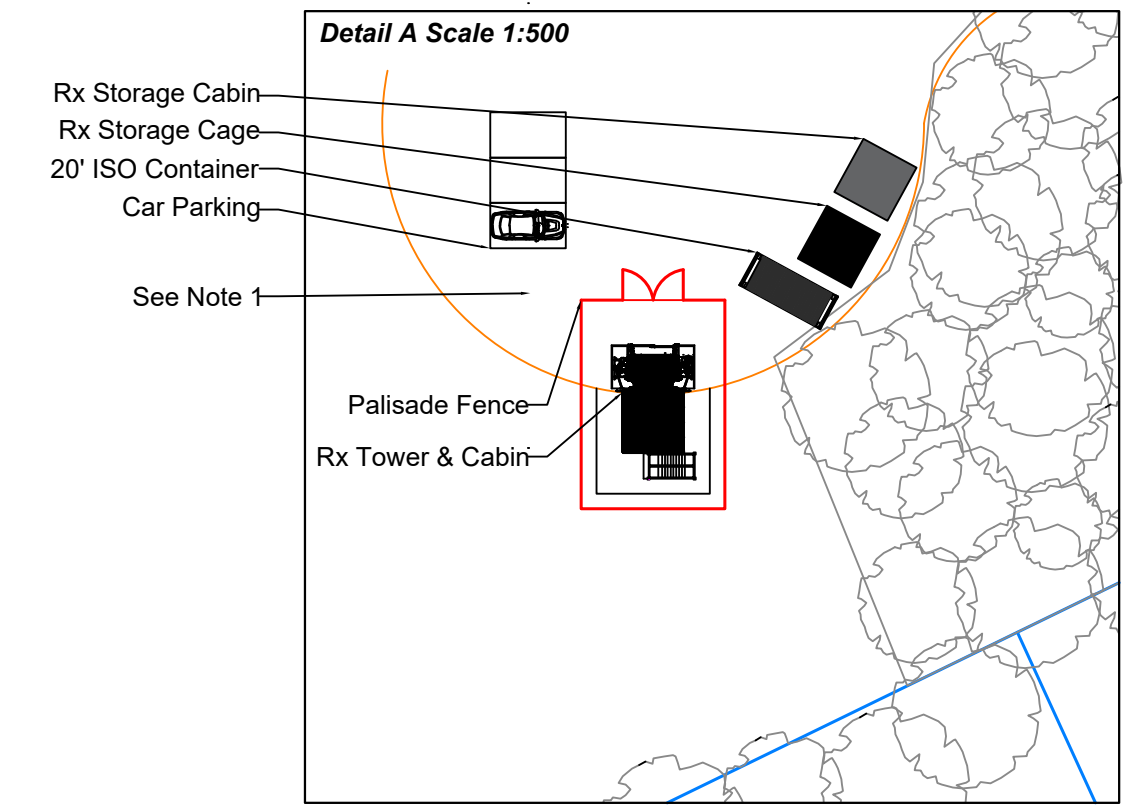
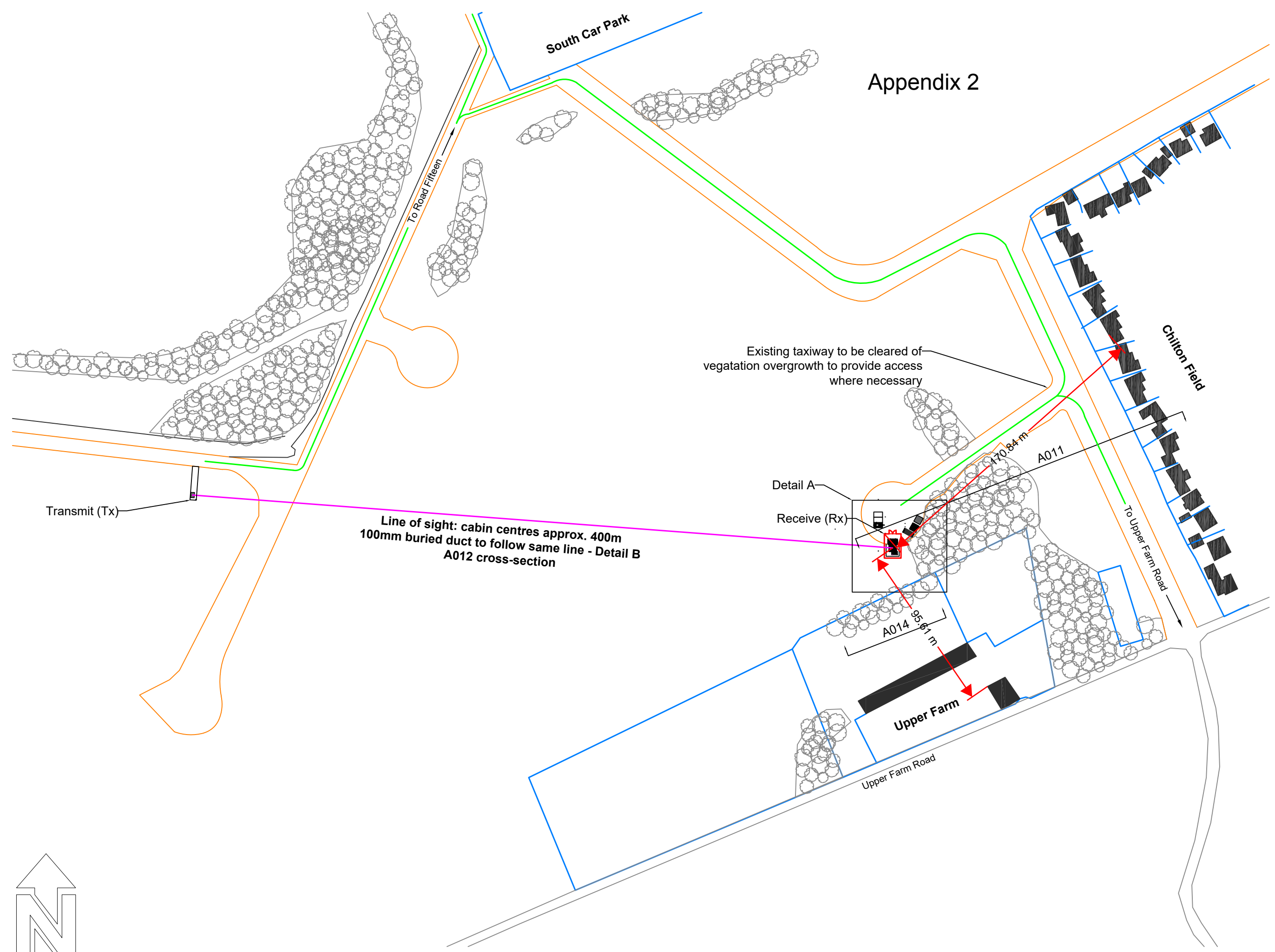

TITLE
LONG SECTION THROUGH THE RANGE

DESCRIPTION

Revision	Revision date	Revision notes
1	21/08/2015	Positioner; contoured to Chilton Field; scale change
2	25/08/2015	Title; antenna pole; distances
3	04/09/2015	Show increased distance; change in height

DRAWING NO.	15058.COM.A011
CLIENT NAME	SAC
PROJECT NO.	15058
ISSUE	Preliminary
REVISION	3
DATE DRAWN	18/08/2015
DRAWN BY	A. Aijo
CHECKED BY	
SCALE	1:2000
SHEET SIZE	A3
PART NO.	N/A
MATERIAL	N/A
TYPE	N/A
FRESH	Refer to drawing

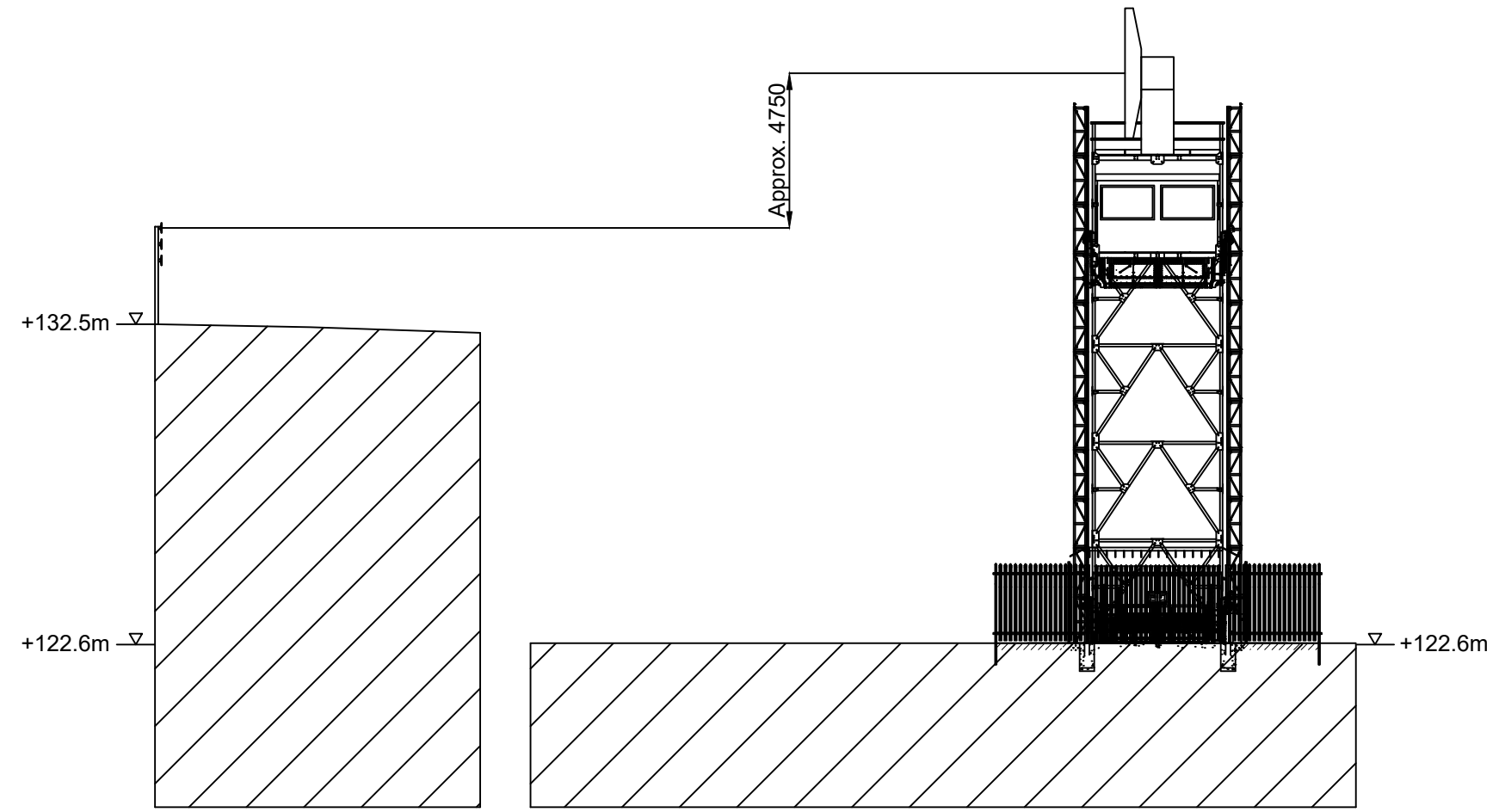
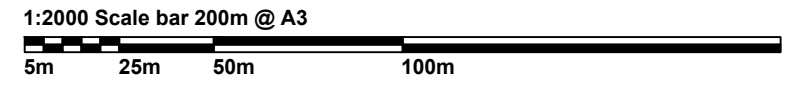
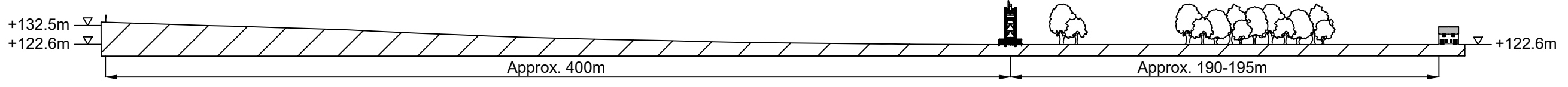

Detail Scale 1:200

SITE ONE
 Unit 18 Nofley Farm, Chairley Road
 Long Crendon, Aylesbury
 Buckinghamshire
 HP18 9ER
 United Kingdom
 T: +44 (0) 1844 208 363
 E: info@siteonesolutions.com

- COMMENTS**
1. Do not scale this drawing.
 2. All dimensions in mm unless otherwise stated.
 3. All material to be grade S275J0 or S355J0 (or J2), in compliance with BS 10025.
 4. All metalwork, including fasteners, to be hot-dip galvanized to BS EN 1416.
 5. All fasteners to be minimum grade 8.8, in compliance with BS 4190, and supplied with a square section spring washer and full nut.
 6. Minimum hole clearance for fasteners should be 1mm greater than the nominal fastener diameter.
 7. No thermal cutting to be used in process. All parts to be laser-cut where possible, including bolt holes. Laser-cutting is not a 'thermal-cutting' process.

TITLE
X-SECTION TO SHOW VIEW FROM CHILTON FIELD

DESCRIPTION

Revision	Revision date	Revision notes
1	21/08/2015	Sight line to windows; sight line to person; tower with antenna
2	25/08/2015	Title
3	04/09/2015	Change distance of tower from trees to show pos'n change

DRAWING NO.	15058.COM.A012
CLIENT NAME	SAC
PROJECT NO.	15058
ISSUE	Preliminary
REVISION	3
DATE DRAWN	18/08/2015
DRAWN BY	A. Aijo
CHECKED BY	
SCALE	1:600
SHEET SIZE	A3
PART NO.	N/A
MATERIAL	N/A
TYPE	N/A
FINISH	Refer to drawing

SITE ONE
 Unit 18 Nofley Farm, Charnley Road
 Long Crendon, Aylesbury
 Buckinghamshire
 HP18 9ER
 United Kingdom
 T: +44 (0) 1844 208 363
 E: info@siteonesolutions.com

- COMMENTS
- Do not scale this drawing.
 - All dimensions in mm unless otherwise stated.
 - All material to be grade S275J0 or S355J0 (or J2), in compliance with BS 10025.
 - All metalwork, including fasteners, to be hot-dip galvanized to BS EN 1416.
 - All fasteners to be minimum grade 8.8, in compliance with BS 4190, and supplied with a square section spring washer and full nut.
 - Minimum hole clearance for fasteners should be 1mm greater than the nominal fastener diameter.
 - No thermal cutting to be used in process. All parts to be laser-cut where possible, including bolt holes. Laser-cutting is not a 'thermal-cutting' process.

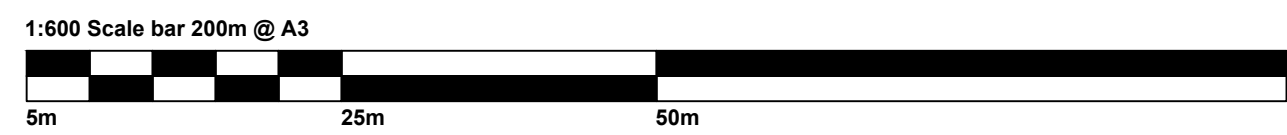
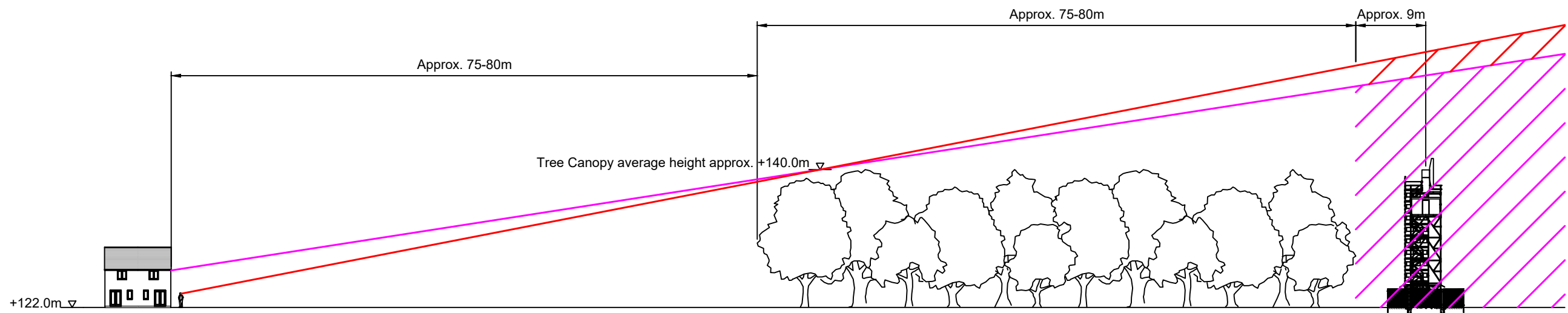

Key

- Line of sight from upper window
- Hidden from window view
- Line of sight from person
- Hidden from garden view

Sites considered in the initial deployment of the Antenna test facility

